

Fans

High performances axial fans

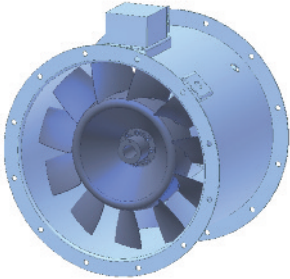

AFH Series

Applications

Brake resistors

Heat exchangers / radiators

Gas turbine enclosures

Forced ventilation

Traction motors

High quality, no-compromise products for applications requiring a guaranteed and reliable component providing high pressures and precise air flows. They are most suitable for applications which require the fan to be a critical part of the system both in terms of performance and reliability. They are used in different applications such as power generation, railway, naval, cement and are always characterized by the demanding and critical nature of the service. Direct coupling solutions with motors from 2 to 8 poles are available, as well as belt-driven solutions for all cases in which it is convenient to decouple the motor from the impeller for service or maintenance. Only top quality components, sized by COMET according to criteria based on 15 years of experience and many industrial applications, are used for the manufacturing of these units. Detailed aerodynamic studies are the basis of the design of the "AFH" Series fans, which feature key characteristics for use in critical applications:

- above average pressures and air flows
- reduced dimensions
- moderate noise
- high reliability
- cost effective solution

The "AFH" Series is the ideal choice when looking for a high performance product of superior quality.

General Characteristics

- Impellers with high-efficiency, low-noise aerofoil type blades, in aluminium alloy
- Three-phase motors IP55/IP65, with Class F or H insulation, 50/60Hz, suitable for inverter supply
- Casings in carbon steel, electro-welded, with anti-corrosive finishing by hot-dip galvanization
- Single or double array of fixed vanes for performance increase, optimized for the application

Wide range of ancillary parts and customizations

Versions with special materials, special dimension, motors according to customer's specifications.

Double-stage or double-impeller solutions for higher performances are available upon request



Microelettrica Scientifica

Fans

High performances axial fans: AFH Series



AFH



Technical data

Series	Diameter [mm]	Characteristics	Pressure	Power [kW]
AFH	360 ÷ 1800	Direct drive	up to 2800Pa (single stage) up to 4000Pa (double stage)	0.55 ÷ 90
AFTH	630 ÷ 1800	Belt drive	up to 2500Pa (single stage)	1.5 ÷ 55



KNORR-BREMSE



Microelettrica Scientifica

Comet Fans S.r.l. Via Leonardo Da Vinci, 17 20020 Solaro - Milano - Italy
Tel. +39 02.96.79.01.43 Fax +39 02.96.93.176 - sales@cometfans.com
www.cometfans.com